

GOLDEN ENGINEERED ELEVATOR LIFT SPECIFICATIONS

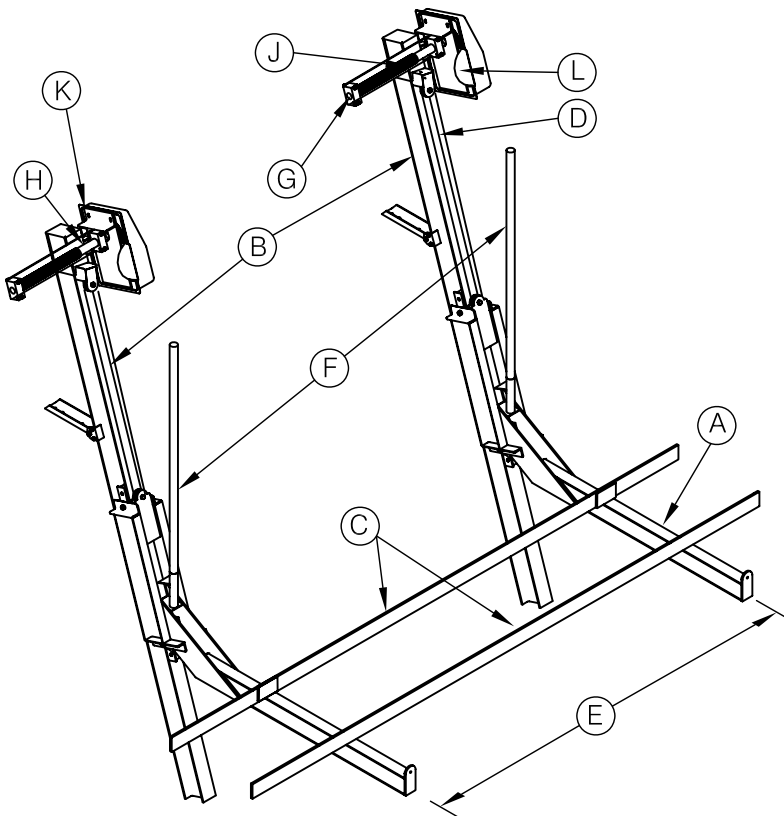

STRUCTURAL ENGINEERING REVIEW

THIS CONSTRUCTION HAS BEEN DESIGNED AS A MAIN WIND FORCE RESISTING SYSTEM, WITH CALCULATED GRAVITY AND WIND LOADS IN COMPLIANCE WITH THE FLORIDA BUILDING CODE 2007, WITH 2009 SUPPLEMENTS, SECTION 1609, ADM 2005, AND ASCE 7-05 "MINIMUM DESIGN LOADS FOR BUILDINGS AND OTHER STRUCTURES" TO WITHSTAND THE WIND LOADS ASSOCIATED WITH A BASIC WIND SPEED OF 150 MPH, EXPOSURE "C". ARNOLD/SANDERS CONSULTING ENGINEERS HAS NO CONTROL OF THE MANUFACTURING, PERFORMANCE, OR INSTALLATION OF THIS PRODUCT. THESE GENERIC PLANS WERE ENGINEERED IN ACCORDANCE WITH ACCEPTED ENGINEERING PRACTICES AND DATA PROVIDED BY THE MANUFACTURER.

Arnold/Sanders Consulting Engineers, Inc.
 Certificate of Authorization 9451
 16681 McGregor Blvd, Suite 102, Ft. Myers, FL 33908
 239-267-3666 Fax: 239-267-2771

J.L. SANDERS
 Reg. Florida No. 66361

Date:

SIGNATURE NOT VALID WITHOUT RAISED SEAL

(2) 3/4"Øx3-1/4"
 EMBED REDHEADS
 @ 4" & 10" FROM
 EDGE

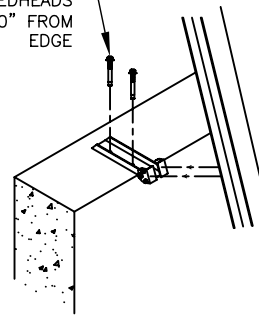

SEAWALL MOUNTING DETAIL

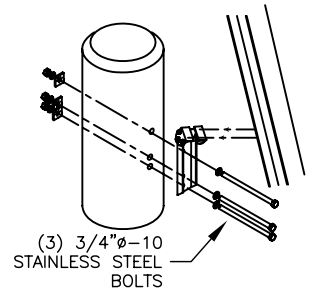

(3) 3/4"Ø-10
 STAINLESS STEEL
 BOLTS

PILE MOUNTING DETAIL

INCLINE MOUNT OR VERTICAL MOUNT

NOTE: THIS STRUCTURE HAS BEEN DESIGNED FOR LOADS ASSOCIATED WITH WIND SPEEDS OF 150 MPH CALCULATED PER FLORIDA BUILDING CODE 2007 WITH 2009 SUPPLEMENTS, ASCE 7-05 AND ADM-2005. BOATS SHALL NOT BE STORED ON LIFTS DURING HIGH WIND EVENTS.

(A) (B) (C) (D) (E) (F) (G) (H) (J) (K) (L)

LIFT CAPACITY	CRADLE I-BEAM	TRACK I-BEAM	BUNK BOARDS FEET	CABLE SIZE	TRACK SPREAD	GUIDE POST HEIGHT	BRGS	DRIVE SHAFT	WINDER DIA	GEAR RATIO	MOTOR HP/VOLTAGE	INCHES OF LIFT PER MIN.
3,000#	(2) 6 H x .19 4 W x .29 x 7' LG @ 4.03#/FT	(2) 8 H x .23 5 W x .35 x 25' LG. @ 6.18#/FT	(2) 2 x 8 x 144 ROUGH SAWN CARPETED	(2) 5/16"Ø x 20' S.S. 2 PART	7' THRU 10'	80"	(4) 2" EXTRUDED 6061-T6 ALUM	(2) 1.900" O.D. x .148" WALL GALVANIZED HSS	(2) 2 1/2"Ø SCHEDULE 80 ALUM. PIPE	480:1	(2) 3/4 HP 120V/20A 240V/10A	13-1/2"
5,000# & 7,000#	(2) 8 H x .23 5 W x .35 x 8' LG. @ 6.18#/FT	(2) 8 H x .25 5 W x .41 x 25' LG. @ 7.02#/FT		(2) 5/16"Ø x 30' S.S. 2 PART	8" THRU 11'						(2) 3/4 HP & 7,000# (2) 1 HP	
10,000#	(2) 9 H x .27 5.5 W x .44 x 8' LG. @ 8.36#/FT	(2) 9 H x .27 5.5 W x .44 x 25' LG. @ 8.36#/FT		(2) 3/8"Ø x 38' S.S. 2 PART							(2) 3/4 HP 120V/20A 240V/10A	
12,000#	(2) 10 H x .25 6 W x .41 x 8' LG. @ 8.65#/FT	(2) 10 H x .25 6 W x .41 x 25' LG. @ 8.65#/FT	(2) 3 x 10 x 192 ROUGH SAWN CARPETED	(2) 3/8"Ø x 38' S.S. 3 PART	8" THRU 14'	120"	(4) 2" EXTRUDED 6061-T6 ALUM	(2) 1.900" O.D. x .165" WALL GALVANIZED HSS	(2) 2 1/2"Ø SCHEDULE 80 ALUM. PIPE	480:1	(2) 3/4 HP 120V/20A 240V/10A	9"
15,000#	(2) 12 H x .29 7 W x .47 x 8' LG. @ 11.7#/FT	(2) 10 H x .29 6 W x .50 x 25' LG @ 10.3#/FT		(2) 3/8"Ø x 50' S.S. 4 PART							(2) 1 HP 120V/20A 240V/10A	6.75"
17,000#	(2) 12 H x .29 7 W x .47 x 10' LG. @ 11.7#/FT	(2) 12 H x .29 7 W x .47 x 25' LG. @ 11.7#/FT		(2) 8 H x .23 5 W x .35 x 25' LG. CAPPED WITH WOOD AND CARPET							(2) 3/8"Ø x 50' S.S. 4 PART	10' THRU 16'
20,000#	(2) 12 H x .31 7 W x .62 x 11' LG. @ 14.3#/FT	(2) 12 H x .31 7 W x .62 x 25' LG. @ 14.3#/FT	(4) 3/8"Ø x 50' S.S. 3 PART		(2) 2 HP 120V/20A 240V/10A	6.75"						
24,000#	(4) 10 H x .29 6 W x .50 x 10' LG. @ 10.3#/FT	(4) 10 H x .29 6 W x .50 x 25' LG @ 10.3#/FT	(4) 3/8"Ø x 50' S.S. 4 PART									
30,000#	(4) 12 H x .31 7 W x .62 x 11' LG. @ 14.3#/FT	(4) 12 H x .31 7 W x .62 x 25' LG. @ 14.3#/FT										